



CONCORDIA COLLEGE
MOORHEAD, MINNESOTA

2024 FALL ORIENTATION EVENT SCHEDULE

SUNDAY, AUG. 25 | Welcome New Cobbers

2:30 p.m.	Blessing the Journey Memorial Auditorium
3 p.m.	Families Depart
3:30 p.m.	Orientation Clubs Form Memorial Auditorium
4 p.m.	First Club Meeting + Activities Club Meeting Locations
5-7 p.m.	*Dinner Anderson Commons, Knutson Campus Center
5-7 p.m.	Music Department Tour Hvidsten Hall of Music
7:30 p.m.	Welcome Show Memorial Auditorium
8:30 p.m.	Residence Hall Time Residence Hall Floors

MONDAY, AUG. 26 | All Things Academic + Hands for Change

7:30-8:30 a.m.	*Breakfast Anderson Commons, KCC
8:30-9 a.m.	Club Time Club Meeting Locations
9:15-10:15 a.m.	Academic Department Advising Previews Various Campus Locations
10:30-11:30 a.m.	Intro to First-Year Seminar Your FYS Classroom (or Club Location)
11:30 a.m.-12:30 p.m.	*Lunch Anderson Commons, KCC
12:30-1 p.m.	Hands for Change Send-off Dovre Campanile
1-1:30 p.m.	Hands for Change Travel Time
1:30-3:30 p.m.	Hands for Change Service Projects Various Locations
3:30-4 p.m.	Hands for Change Travel Time
4-4:30 p.m.	Hands for Change Debrief Your FYS Classroom (or Club Location)
4:30-5 p.m.	Break
5-7 p.m.	*Dinner with Residence Hall Floor Anderson Commons, KCC
6-7:30 p.m.	Worlds of Talent Fair Memorial Auditorium Concourse
7:30 p.m.	Worlds of Talent Memorial Auditorium

***BRING YOUR
COBBER ID**

ConcordiaCollege.edu/Orientation

TUESDAY, AUG. 27 | Resource Rotations + Dramatic Dialogues

8-9 a.m. *Breakfast | Anderson Commons, KCC

CLUBS 1-12 + TRANSFER

9-9:15 a.m. Club Time | Club Meeting Locations

9:15 a.m.-Noon Resource Rotations | Various Campus Locations

CLUBS 13-26

9-9:30 a.m. Club Time | Club Meeting Locations

9:30-11:30 a.m. Dramatic Dialogues | Frances Frazier Comstock Theatre

11:30 a.m.-Noon Dramatic Dialogues Debrief | Club Meeting Locations

Noon-1 p.m. *Lunch | Anderson Commons, KCC

CLUBS 1-12 + TRANSFER

1-3 p.m. Dramatic Dialogues | Frances Frazier Comstock Theatre

3-3:30 p.m. Dramatic Dialogues Debrief | Club Meeting Locations

3:30-4 p.m. Club Time | Club Meeting Locations

CLUBS 13-26

1-3:45 p.m. Resource Rotations | Various Campus Locations

3:45-4 p.m. Club Time | Club Meeting Locations

4-6:30 p.m. Cobb Hobnob | North Mall and Various Campus Locations

5-7 p.m. *Dinner on Your Own | Anderson Commons, KCC

7-9 p.m. Belonging Bash | Dovre Campanile

WEDNESDAY, AUG. 28 | First Day of Classes

7:30-8:10 a.m. *Breakfast on Your Own | Anderson Commons, KCC

8:10-8:30 a.m. Convocation Lineup | Dovre Campanile

8:30-9:15 a.m. Convocation | Memorial Auditorium

9:30-9:40 a.m. Beanie Toss | Olin Hill

9:45 a.m. Classes Begin | Your FYS Classroom

*BRING YOUR
COBBER ID





**CONCORDIA
COLLEGE**
MOORHEAD, MINNESOTA

CAMPUS MAP

901 8th St. S., Moorhead, MN 56562 | For information, call 218.299.4000

ConcordiaCollege.edu

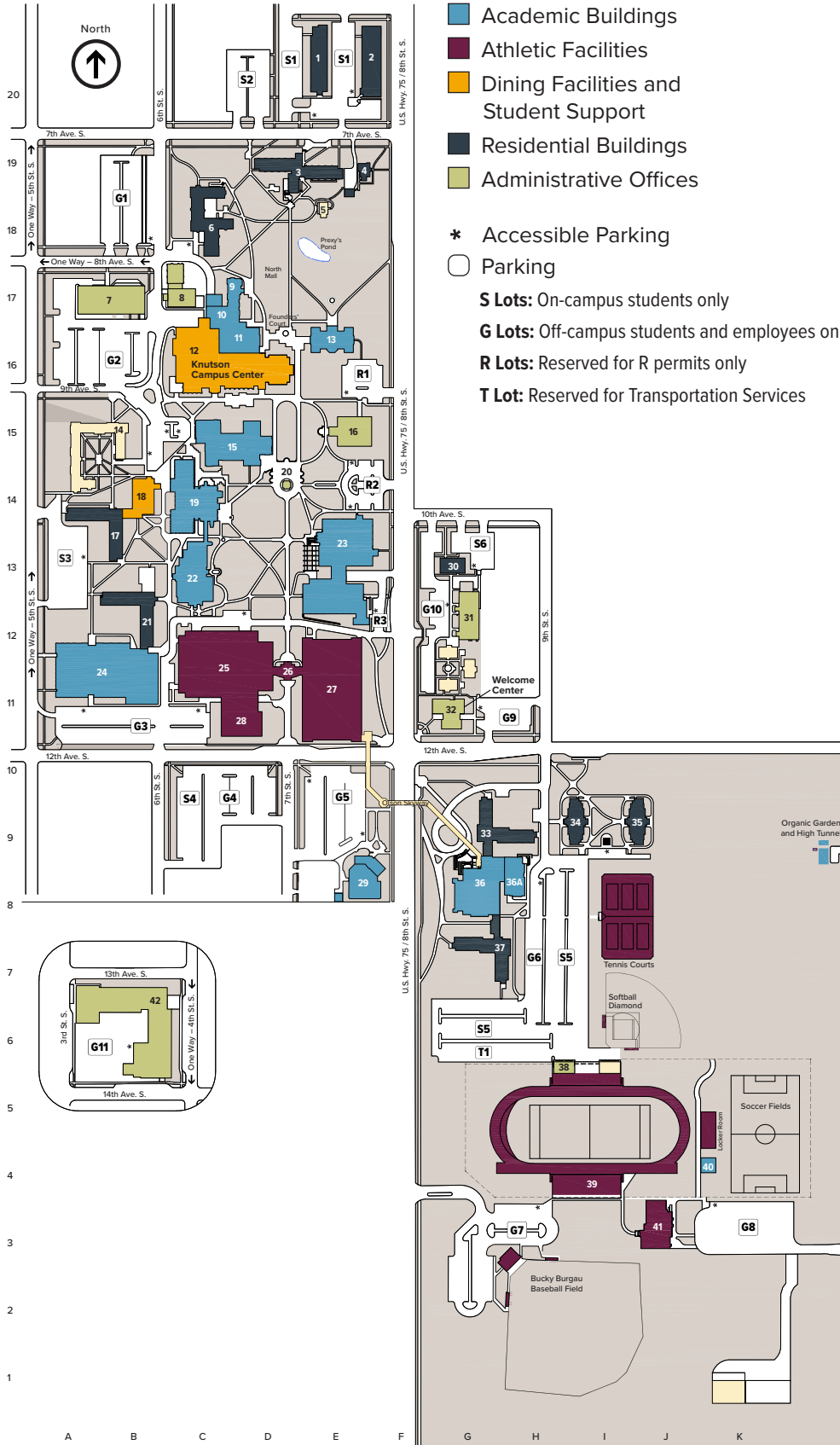

- | | |
|--|-----|
| 1. Bogstad Manor | E20 |
| 2. Bogstad East | F20 |
| 3. Park Region Hall | D19 |
| 4. President's Residence | E19 |
| 5. Aasgaard House | E18 |
| 6. Fjelstad Hall | C18 |
| 7. Mugaas Plant Operations Center | B17 |
| 8. Berg Steam Plant | C17 |
| 9. Bishop Whipple Hall | D17 |
| 10. Grose Hall | C17 |
| 11. Academy Hall | D12 |
| 12. Knutson Campus Center | C16 |
| Campus Information | |
| Centrum | |
| Morrie Jones Conference Center | |
| 13. Old Main | E16 |
| 14. Brown Hall | B15 |
| 15. Carl B. Ylvisaker Library | D15 |
| 16. Lorentzen Hall | E15 |
| 17. Livedalen Hall | B14 |
| 18. Normandy Center | C14 |
| Bookstore | |
| Center for Student Success | |
| 19. Frances Frazier Comstock Theatre | C14 |
| Cyrus M. Running Gallery | |
| 20. Dovre Campanile | D14 |
| 21. Hoyum Hall | B12 |
| 22. Olin Art and Communications Center | C13 |
| TV-radio studios | |
| 23. Integrated Science Center | E13 |
| Jolicoeur Commons | |
| Fuglestad Lecture Hall | |
| 24. Hvidsten Hall of Music | B11 |
| Christiansen Recital Hall | |
| 25. Memorial Auditorium | C12 |
| 26. Offutt Concourse | D11 |
| Birkeland Alumni Lounge | |
| 27. Olson Forum | E11 |
| 28. Swimming Pool | D11 |
| 29. Heimarck Center | E8 |
| 30. Boe-Olsen Apartments | G13 |
| 31. Advancement Center | G12 |
| 32. Welcome Center | F11 |
| 33. Hallett Hall | G9 |
| 34. Townhouse West | I9 |
| 35. Townhouse East | J9 |
| 36. Grant Center | G8 |
| Offutt School of Business | |
| 36A. Barry Auditorium | |
| 37. Erickson Hall | G7 |
| 38. Transportation Maintenance | H6 |
| 39. Jake Christiansen Stadium | H5 |
| 40. Observatory | J4 |
| 41. Thorson Athletic Center | J3 |
| 42. Riverside Center (see inset) | B6 |